



IPSWICH

BOROUGH  
COUNCIL



Supported by the  
Heritage Lottery Fund

Wessex Archaeology



## General Information

The Heritage Lottery Fund have given Ipswich Borough Council a project planning grant to pay for the investigations needed before work can begin to restore Holywells Park.

As part of this essential preparatory work a team from Wessex Archaeology Ltd will be excavating trial trenches at various sites around the park. As you walk around, you will find information about the areas where they are working. The team will be happy to answer any questions about what they are doing.



# General Information

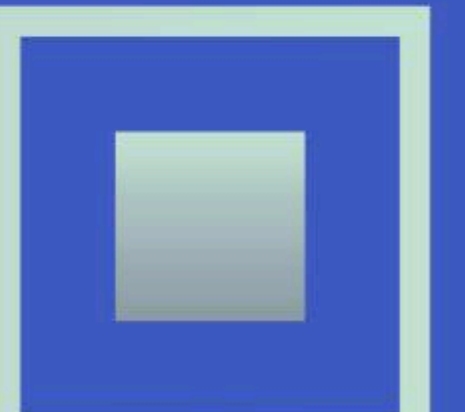



IPSWICH

BOROUGH COUNCIL



Supported by the Heritage Lottery Fund

Wessex Archaeology



## Historic Background

The park has a long history. Flint tools from the Stone Age have been found at Holywells, while Bronze Age axes and Roman coins have been discovered nearby.

The earliest written records tell us that the area was part of the manor of Wyks Bishop, held by the Bishops of Norwich from the 13<sup>th</sup> century, but we do not know whether or not they had a house on the site.

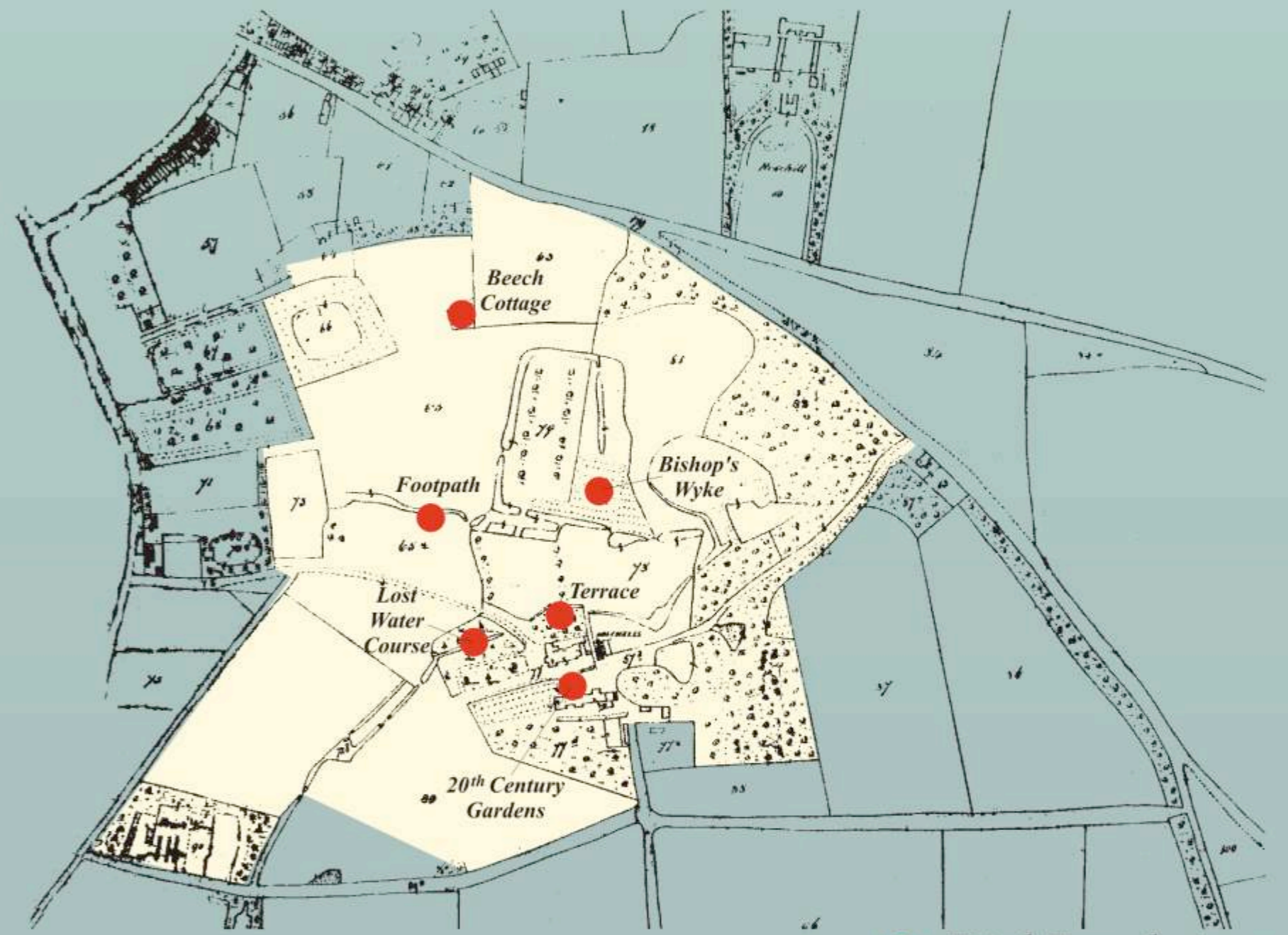

● Trial Trench Area  
1846 Tithe Map

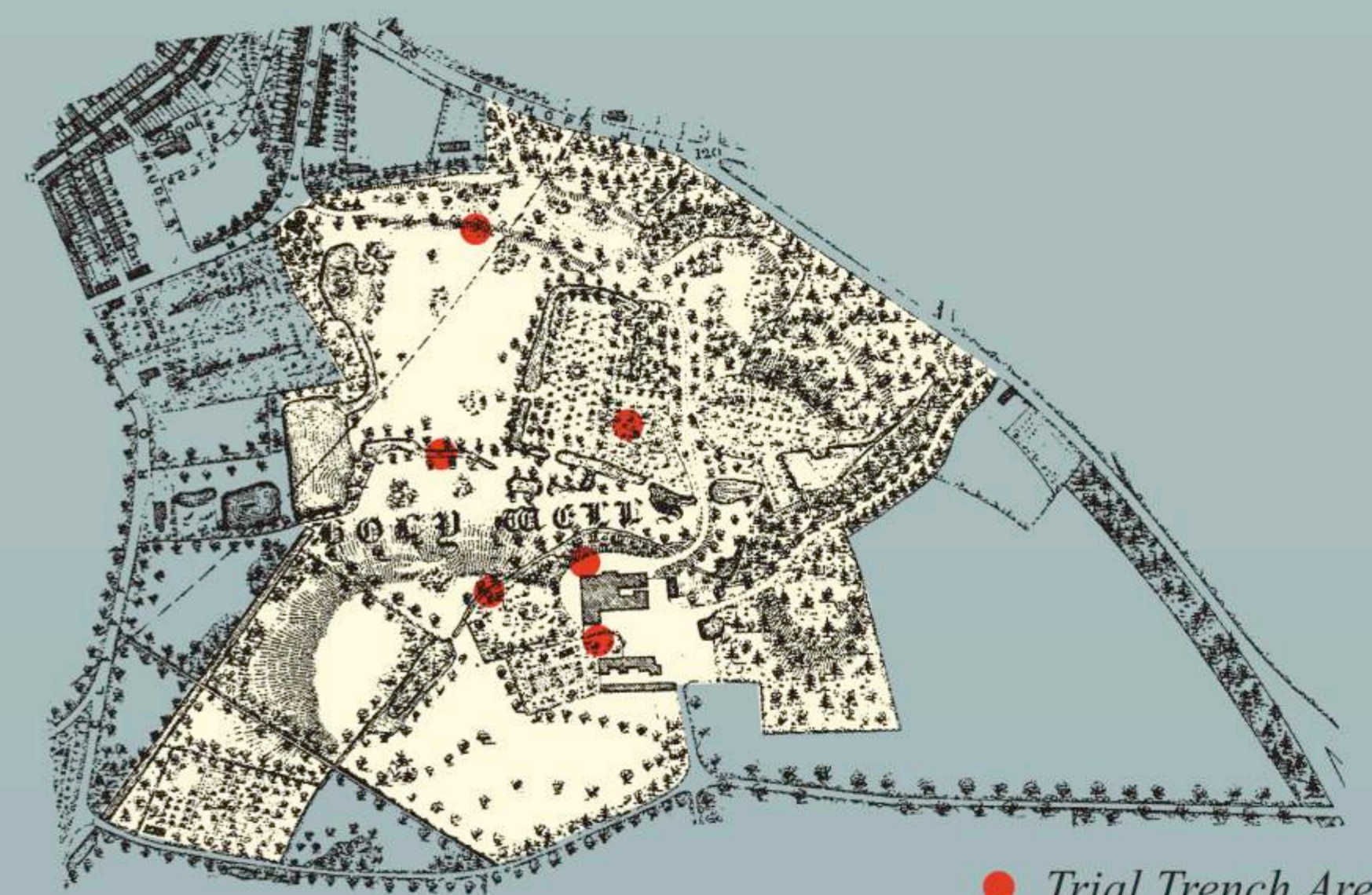

● Trial Trench Area  
1876 Map

1864 Holy Wells Ipswich Horticultural Show



1867 by Rev. Richard



In the 16<sup>th</sup> century the manor passed into private hands and during the 18<sup>th</sup> and 19<sup>th</sup> centuries many of the owners were brewers. In 1812 the manor was bought by John Cobbold, whose brewery had for many years used the water from Holywells to make beer. A brick maker occupied part of the site in the late 18<sup>th</sup> century and there is mention of a farm Pitts Farm from the 16<sup>th</sup> century.

1876 Holy Wells Residence of J.C.Cobbold. Esq

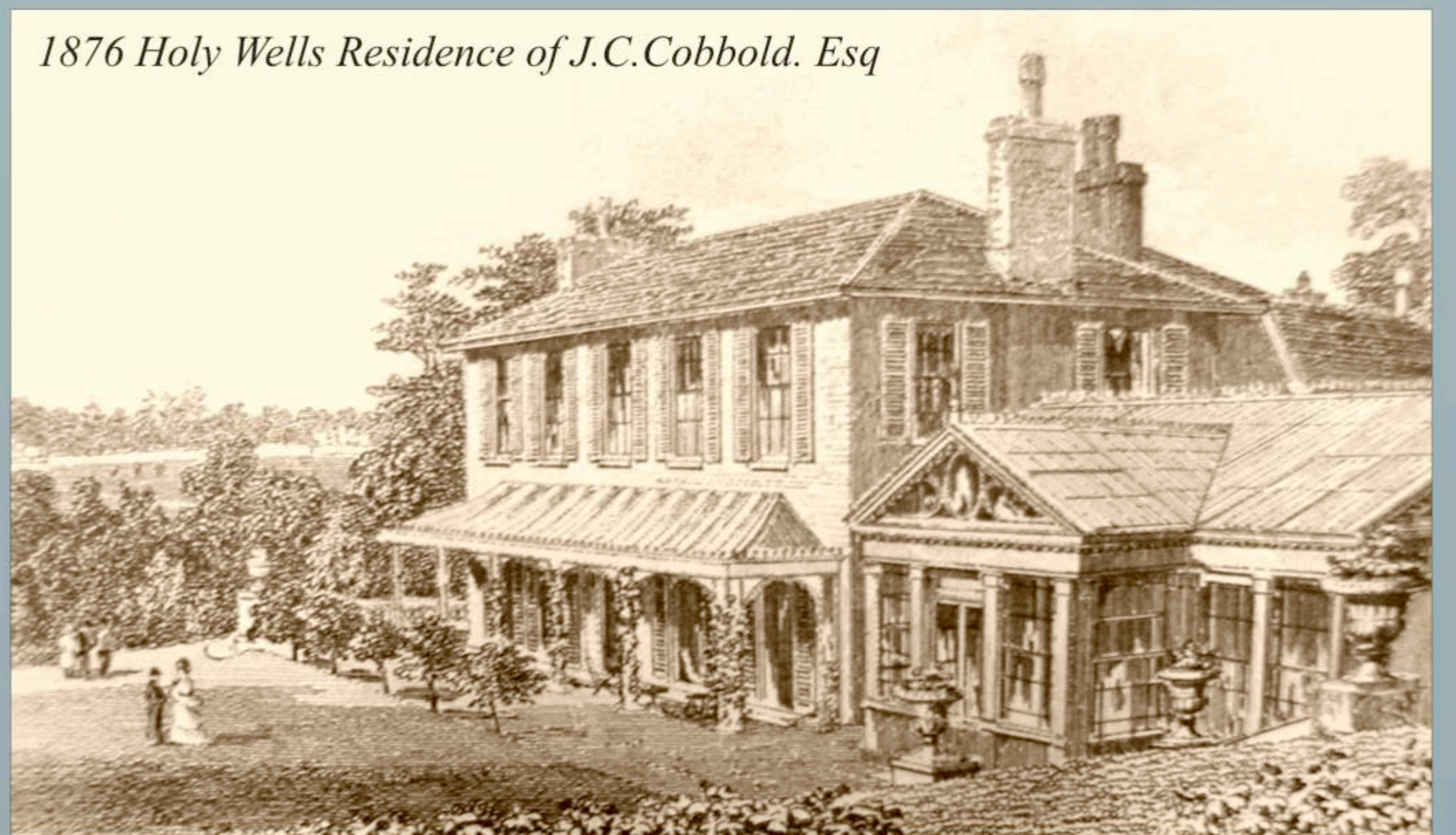

Excavation will tell us more of the story of this fascinating site.

# Historic Background

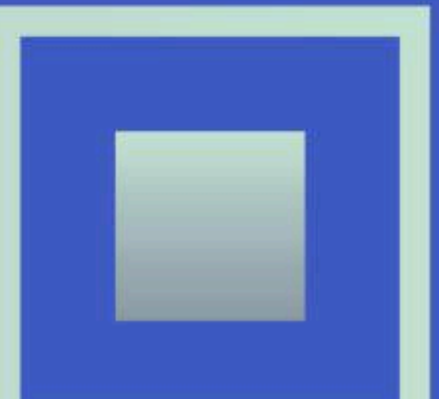



IPSWICH  
BOROUGH  
COUNCIL



Supported by the  
Heritage Lottery Fund

Wessex Archaeology



## Terrace

Under the ground you are treading on lie the older structures and surfaces of the terrace. Excavation will help us build a picture of the sequence of their construction.



1867 by Rev. Richard





IPSWICH  
BOROUGH  
COUNCIL



Supported by the  
Heritage Lottery Fund

Wessex Archaeology



## Footpath

The path here will be made wider, but before this happens we are looking to see if there are any traces of historic field boundaries or older paths along this route. We are also looking for evidence of water courses in this area.

1863



1748-50 Holywells Park by Gainsborough



Footpath



## Twentieth Century Garden

In order to recreate the 20<sup>th</sup> century garden, we are first looking for evidence of the way the old paths and beds were laid out.





IPSWICH  
BOROUGH  
COUNCIL



Supported by the  
Heritage Lottery Fund

Wessex Archaeology



## Bishop's Wyke

Restoration of the moat around Bishop's Wyke is being considered. First we need to find out the extent of the ditch and, if possible, how old it is. We are also searching for any evidence of a garden shown on early 19<sup>th</sup> century maps to the east side of Bishop's Wyke.

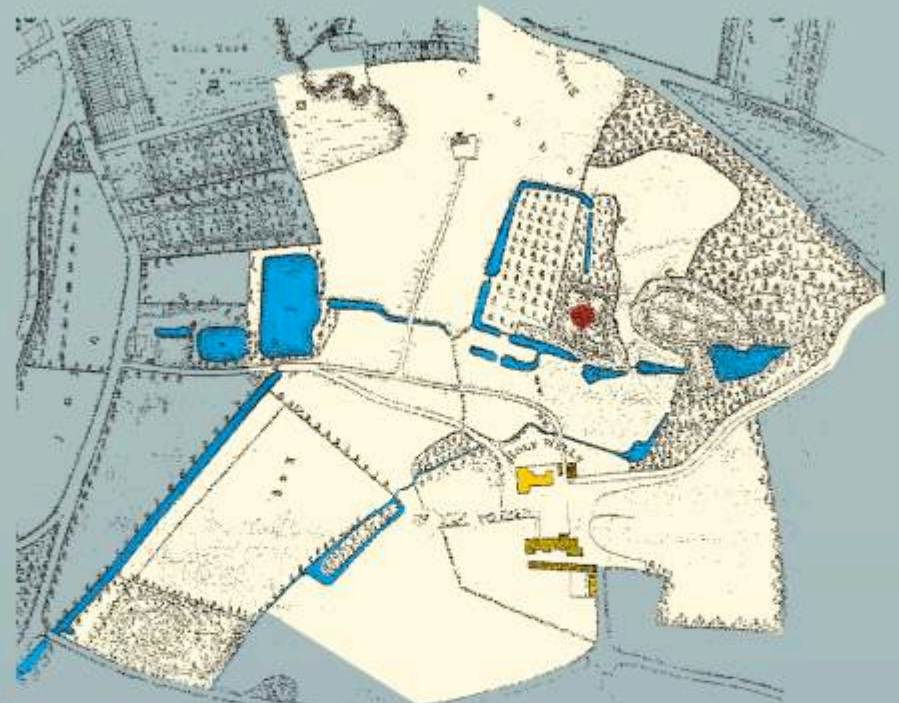

● Bishop's Wyke Trench Area  
1850 Map

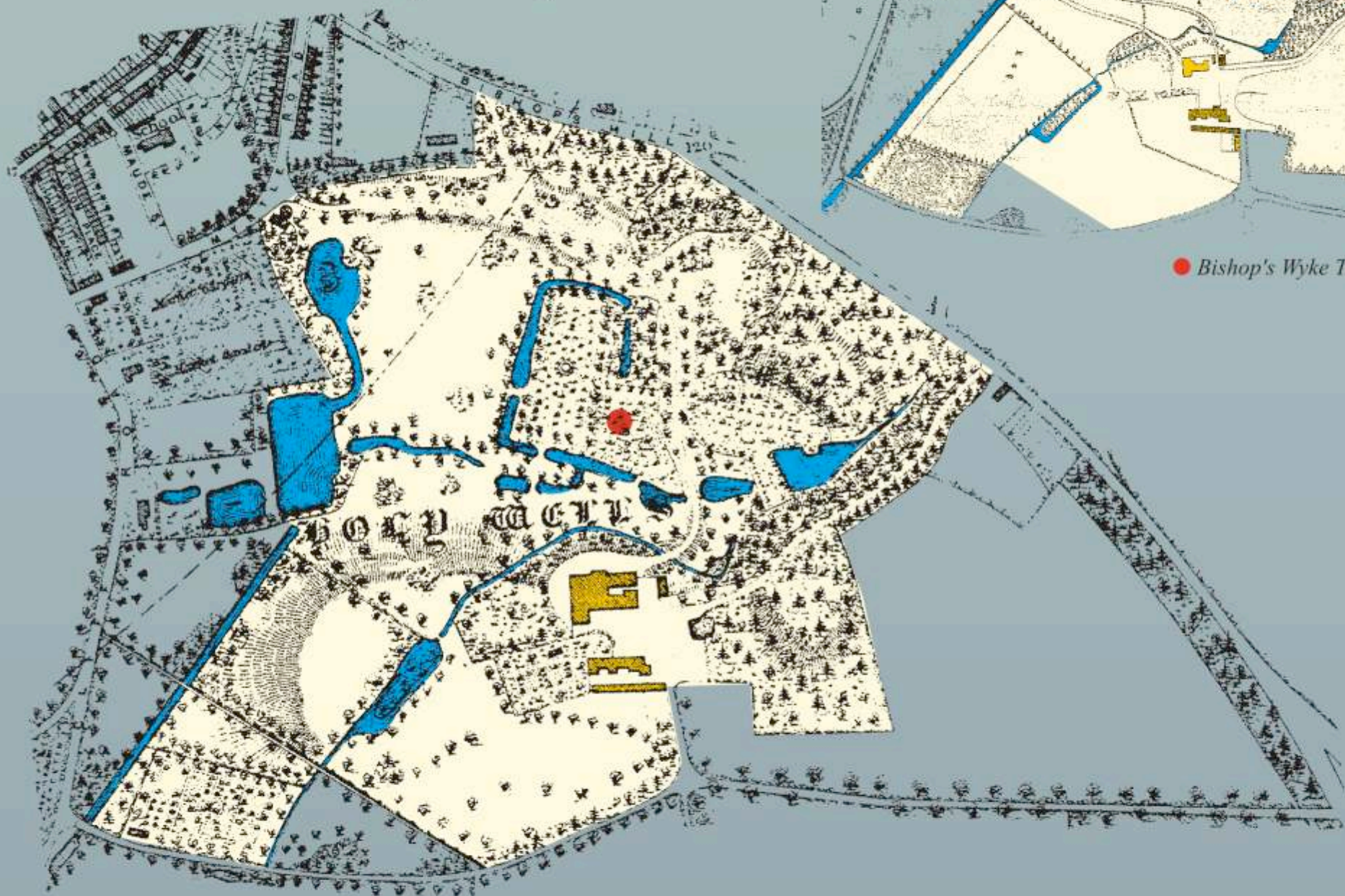

1867 Map

Bishop's Wyke





**IPSWICH**  
BOROUGH  
COUNCIL



Supported by the  
**Heritage Lottery Fund**

**Wessex Archaeology**



## Beech Cottage

In this area we are trying to establish the ground plan and the date of a cottage shown on early 19<sup>th</sup> century maps.

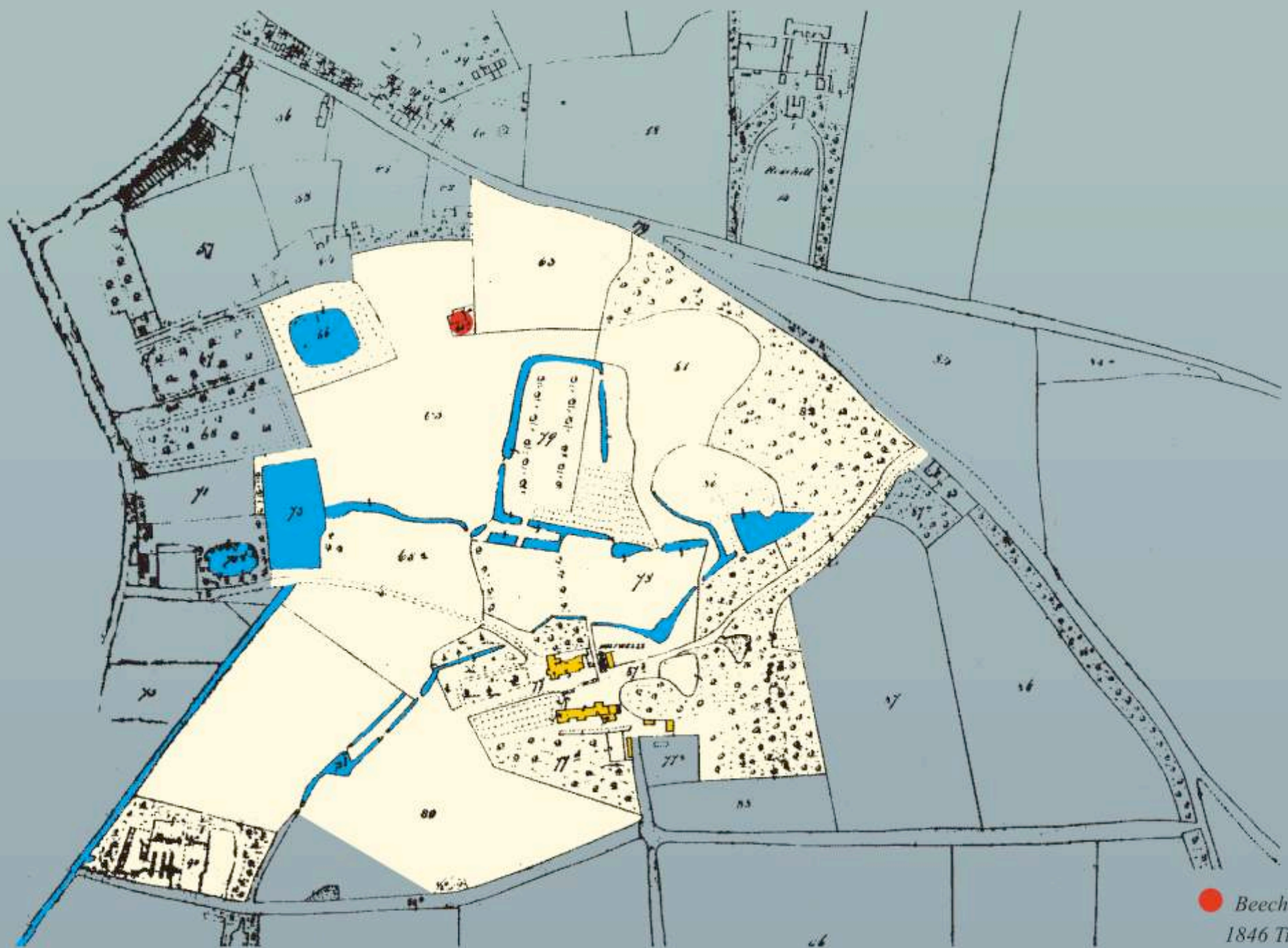

● Beech Cottage  
1846 Tithe Map

*Beech Cottage*

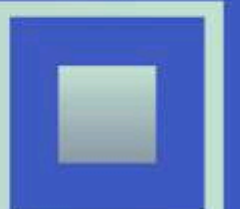

## A Lost Water Course

There was once a sophisticated system of water management at Holywells Park. We are searching for traces of an old water course that led to fishponds.



● Lost Water Course  
1867 Map

